



## CABANA 240

### DESCRIPTION

There's a sense of freedom that comes from being on the water, whether you're savoring steaming mugs of coffee on a cool morning, preparing snacks on a daylong adventure filled with swimming, water toys and fun, or simply cruising along the shoreline, scouting for wildlife or admiring the lake homes. The Cabana 240 gives you everything you need to bring these shimmering visions to life. Not only is this 24-foot pontoon boat easy to manage, with gentle manners, reliable performance and predictable handling, it can accommodate up to 200 HP on two pontoons and up to 300 HP on three pontoon tubes. It also has a variety of floorplans to choose from. The CS and DL floorplans will delight cruisers, who will revel in the spacious lounges and comfortable sunpads, while anglers will appreciate the FC (fish and cruise) configuration with its built-in livewell and fishing station. Add to that the large Bimini top and changing room, with available options such as a double Bimini with enclosure, shore charger and soft-sided cooler, and you have everything you need for the 240 to become a customized, well-loved, stress-free home away from home.

### SPECIFICATIONS

OVERALL LENGTH	25' 6"	7.77 m
PONTOON LOG LENGTH	24'	7.32 m
PONTOON DIAMETER	25"	63.50 cm
BEAM	8' 6"	2.59 m
APPROX. BASIC HULL WEIGHT	3527 Lbs	1,599.82 kg
MAX PERSON CAPACITY	13-16	
MAX WEIGHT CAPACITY	2557 lbs - 3205 lbs	1,159.83 kg - 1,453.76 kg
FUEL CAPACITY	30 gal (2 tubes) 30 gal (PP) 40 gal (PP+) 50 gal (T3 pkg)	113.56 l (2.00 tubes) 113.56 l (PP) 151.42 l (PP+) 189.27 l (T3.00 pkg)
MAX HP CAPACITY	200 HP (2 tubes) 300 HP (3 tubes)	149.14 kw (2.00 tubes) 223.71 kw (3.00 tubes)

## STANDARD FEATURES

---

### CARPET

---

Island Cove Carpet

Rear Vinyl

### CONVENIENCE FEATURES

---

12 volt DC receptacle

Bimini, 10' (1.25" frame w. SST quick release)

Cover, mooring (snap system)

Fire extinguisher, manual

Gate floor stops

Helm Storage Door

Keel, full length, extruded (3/8 inch thick)

Ladder, 4-step telescopic/fold down (stern)

Lighting, courtesy

Lockable Glovebox

Lowback Non-reclining Helm Seat

Removable Windscreen

Stainless Steel Cleats

Steering, tilt (incl with hydraulic or PAS steering)

Woodgrain Table with Drink Holders

### GAUGES

---

Gauges, analog (tach, hour, trim, fuel, volt)

Tachometer

### RADIO

---

Jensen Stereo - incl 2 Jensen spkrs, MP3/USB/Aux

## OPTIONS

---

### ACCENT COLOR

---

Black Sand Accent

Canyon Red Accent

Dune Accent

Ocean Blue Accent

Silver Accent

### BIMINI

---

Standard Black 10' Bimini (Included Only with Black Sand, True Red, Pewter Panel Color)

Standard Blue 10' Bimini (Included Only with Ocean Blue Panel Color)

Standard Tan 10' Bimini (Included Only with Dune Panel Color)

Sport Bimini, 11'6" Silver Anod Frame (restrictions apply - see dealer for details)

### CANVAS

---

Bimini, 12' (1.25" frame w. SST quick release)

Bimini, 12' Lighted

Bimini, double - na LED lights or power top

Full Enclosure - incl. double Bimini

Seat Covers, Canvas (TAN) w. Mooring Cover

Seat Covers, Canvas (TAN) without Mooring Cover (Deletes Standard Mooring Cover)

Silver Anodized Double Sport Bimini

## *COLORS*

Black Sand  
True Red  
Dune  
Ocean Blue  
Pewter

## *COMFORT & CONVENIENCE*

Auto Retract SST Telescopic Ladder  
Battery disconnect switch, single (incl 1 battery tray)  
Battery on-shore charger, 120V  
Battery selector switch, double (incl 2nd battery tray)  
Changing room w. curtain  
Cleats, SST flip-up 5.5"  
Cooler, soft-sided w/ Logo  
Cupholders, lighted  
Docking lights, under deck LED  
Fenders, 2 additional fenders w. straps  
Fenders, quick release (2 fenders, 2 straps, 4 quick release)  
Grill, SST (Req. Ent. Center/Galley)  
Grill, SST Fence Mounted (dealer install)  
Lighting, rope (at seat base) - na courtesy lights  
Lighting, under deck (incl. LED Ladder lights)  
Lighting, underwater LED (2)- (incl. LED Ladder lights)  
Mooring eyes, midship  
National Flag  
Porta Potti  
SST Swim Seat  
Stainless Steel Vinyl Rubrail Insert  
Woodgrain Portable Cupholder (1)

## *ENGINES*

Mercury 9.9 ELPT CT 4S  
Mercury 25 ELPT 4S EFI  
Mercury 30 ELPT 4S EFI  
Mercury 40 ELPT BF 4S EFI  
Mercury 50 ELPT BF 4S EFI  
Mercury 60 ELPT BF 4S EFI  
Mercury 75 ELPT 4S EFI  
Mercury 90 ELPT 4S EFI (Non-Command Thrust)  
Mercury 90 ELPT 4S EFI (Command Thrust)  
Mercury 115 ELPT 4S EFI (Non-Command Thrust)  
Mercury 115 ELPT 4S EFI (Command Thrust)  
Mercury 150XL EFI 4S (incl Hyd Strg, req. lifting strakes & skin kit)  
Mercury 175 Verado (incl Hyd Strg/DTS, req. lifting strakes & skin kit)  
Mercury 200 Verado (incl Hyd Strg/DTS)  
Mercury 200 Pro Fourstroke L6 (incl PAS/DTS) (na Perf Pkg & Perf Pkg PLUS)  
Mercury 225 Verado (incl PAS/DTS)  
Mercury 250 Verado (incl PAS/DTS)  
Mercury 300 Verado (incl PAS/DTS)  
Honda BF 25 DKLRT (incl F/W separator)  
Honda BF 40 DKLRTA (incl F/W separator)  
Honda BF 50 DKLRTA (incl F/W separator)  
Honda BF 75 DKLRTA (incl F/W separator)  
Honda BF 90 DKLRTA (incl F/W separator)  
Honda BF 115 DLA (incl Hyd Strg, F/W separator)  
Honda BF 150 AKL (incl Hyd Strg, F/W separator, req. lifting strakes & skin kit)  
Honda BF 200 AIL (incl Hyd Strg, F/W separator)  
Honda BF 225 AIL (incl Hyd Strg, F/W separator)  
Honda BF 250 ALA (incl Hyd Strg, F/W separator)  
Torqeedo electric motor, 4.0 Cruise (batteries not included) (Req CS Floorplan)

## FISHING

---

Dash Mounted Fishfinder - Lowrance Hook 3X  
Raymarine A68 Chartplotter w. Sonar (Mounting location varies by model)  
Livewell, aerated (furniture drop-in) (na w. Polk Stereo Upgrade & 4 Speaker Upgrade)  
Trolling motor half gate - req LX or FS Floorplan

## FLOORING

---

Berber Marine-grade Carpet  
Main Vinyl  
Main Teak Vinyl  
Main Beachwood Vinyl  
Main Light Woven Teak  
Main Dark Woven Teak  
Main Gray Woven Teak  
Main Gray Seagrass  
Main Woven Shadow Diamonds  
Rear Teak Vinyl  
Rear Beachwood Vinyl  
Rear Light Woven Teak  
Rear Dark Woven Teak  
Rear Gray Woven Teak  
Rear Gray Seagrass  
Rear Woven Shadow Diamonds  
Snap-in Berber Carpet w/ Full Vinyl Flooring - na FS Floorplan  
Snap-in Woven Diamonds w/ Full Vinyl Flooring - na FS Floorplan

## FURNITURE

---

Upgrade to Woodgrain Table w/ Drink Holders  
Additional Black Acrylic Table w/ Stemware & Drink Holders  
Additional Woodgrain Table w/ Drink Holders  
Adjustable Height Seat Base w/ slider/swivel - na raised helm, salt water pkg II or bolster seat  
Jump Seat - na FS Floorplan  
Aft Jump Seat - na FS Floorplan  
Fishing Seat Upgrade (2) req. FC Floorplan  
Highback Reclining Helm Seat  
Dual Highback Helm Seats - Dual Helm Seats  
Lowback Reclining Helm Seat  
Lowback Reclining Helm Seats - Dual Helm Seats

## GRAPHIC COLOR

---

Lime Green Sport Graphic  
Silver Sport Graphic

## HELM

---

Digital Depthsounder  
Gauge, SmartCraft MercMonitor  
Steering Wheel Upgrade - Sport

## INTERIOR COLOR

---

Alabaster

## PACKAGES

---

Convenience Package: Portable Cupholder, Sport Steering Wheel Upgrade, Flip-up Cleats, Kick Plates, Quick Release Fender System  
Lighting Package: Lighted Cupholders, Courtesy Rope Lighting, Underwater Lights, Ladder Lights, Underdeck Lights

## PERFORMANCE & HANDLING

---

Salt Water Pkg II (rotocast helm seat, 4 anodes, riveted hinges, alum gate hinges)

SALTWTR PKG II-W/DUAL HELM SEATS\*

Performance Package Plus - req. hydraulic steering (max 200 HP - na 200 Pro4S L6)

T3 Package (incl 3rd tube, skin kit, lifting strakes, rough water pkg) - req hyd strg

Xtreme Steering (for engines <115hp) (na Hyd & PAS Steering)

Hydraulic steering (for engines <115hp)

PAS - Power assist steering (for Non-Verado engines < 225hp)

PAS - Power assist steering (for Verado engines < 225hp)

Salt water pkg I (4 anodes mounted)

In-Floor Storage w/ Bilge - req. Performance Package Plus

Ski locker, incl auto bilge pump - Req T3/Twin Engine Platform, NA w. Perf Pkg PLUS

Ski tow bar, SST (na w/ Twin Engine Platform)

Ski tow pylon, heavy-duty SST- req T3 (na w/ Twin Engine Platform & Perf Pkg PLUS)

Skin kit, aluminum (incl. w/ perf pkgs/T3/Twin Engine Platform)

Lifting Strakes - recom 90hp & up (incl. w/ perf pkgs/T3/Twin Engine Platform)

## PILLOW TOP INTERIOR STYLING

---

Pillow Top, Alabaster

## STEREO & SOUND

---

Polk Bluewater Sound System Upgrade (incl amp, Polk stereo, 6 Polk spkrs, subwoofer) - na w/ FS floorplan

Polk stereo - incl 4 Jensen speakers

Speakers, 2 additional Jensen (na w/ Livewell or Polk Stereo Upgrade)

Speakers, lighted - na Polk upgrade & Polk Bluewater (not incl on rear ext. speakers)

Speakers, lighted SST covers - req Polk upgrade or Polk Bluewater (not incl on rear ext. speakers)

Speakers, Polk upgrade (4 Speakers, Recommend Polk Head Unit)

Speakers, SST cover - req Polk speakers

## FLOORPLANS

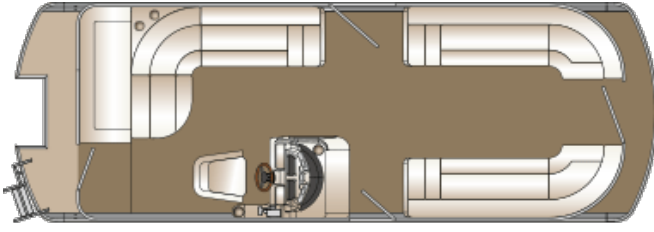

CS - L group (Standard)

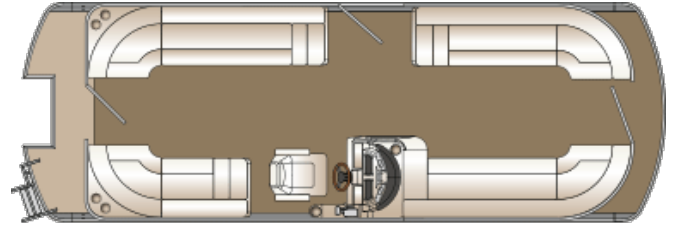

CW - Center Walkthru

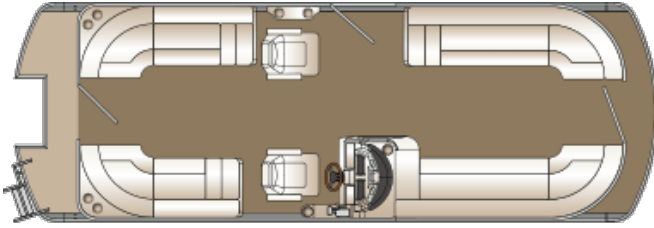

CWDH - adds dual helm seat

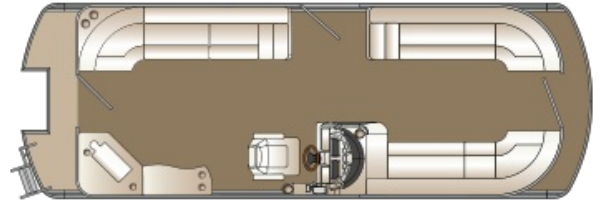

CWEC - Center walkthru w/ entertainment center

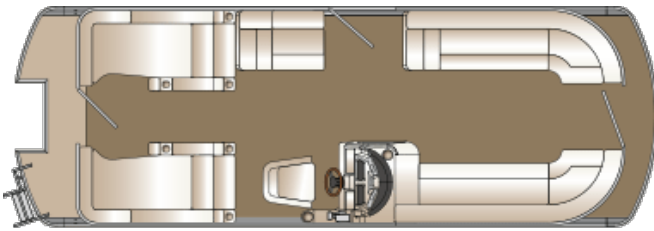

DL - Dual Rear Facing Loungers

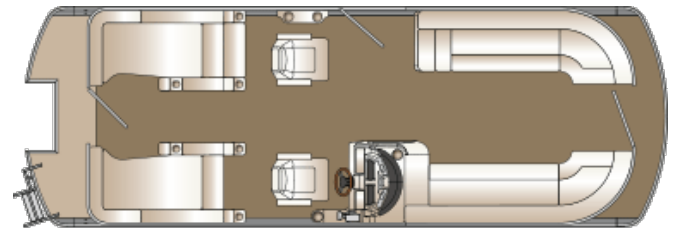

DLDH - adds dual helm seat

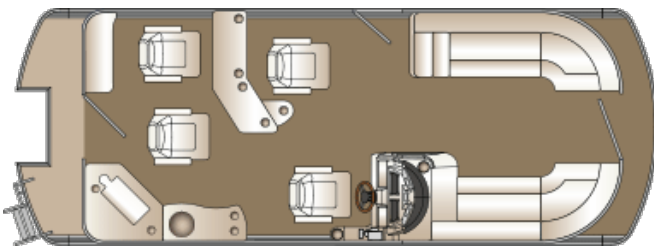

EGDH - Entertainment Galley & Dual Helm Seats - req lighted cupholders